



Assembly, Care and Usage Instructions



Product #820-444

Instruction #1011136

STOP!

If you have a problem with this product, **DON'T RETURN IT TO THE STORE WHERE YOU PURCHASED IT.** Contact customer service at...

Battenfeld
Technologies, Inc.

5885 West Van Horn Tavern Road / Columbia, MO 65203
573-445-9200 / Email: sales@battenfeldtechnologies.com
Or visit our website @ www.battenfeldtechnologies.com

NOT WARRANTED AGAINST MISUSE, ABUSE, OR COMMERCIAL USE.

Limited Warranty

Every Caldwell product is warranted to be free of defects in materials and workmanship for a period of one (1) year from the date of original purchase. Caldwell will, at its option, repair or replace without charge, except for transportation costs, parts that fail under normal use and service when operated and maintained in accordance with our Instructions. This warranty does not apply to normal wear or to items whose life is dependent upon their use and care. This warranty is in lieu of all other warranties, expressed or implied and releases Caldwell, its affiliates, and its vendors from all other obligations and liabilities.



WARNING: IMPORTANT SAFETY INFORMATION!

- Always practice safe firearm handling
- Always hold the forend of the firearm when shooting off of this shooting rest or any rest. If it is not held, the recoil can cause the forend to jump out of the front bag, possibly causing damage to the firearm or injuring the shooter.

Thank you for purchasing a Caldwell Lead Sled® FCX. The Lead Sled® FCX comes to you partially assembled please take a moment to locate all of the parts before you begin. (See Photo I) Since we are always trying to improve our products, some components may vary slightly in appearance.

Photo I

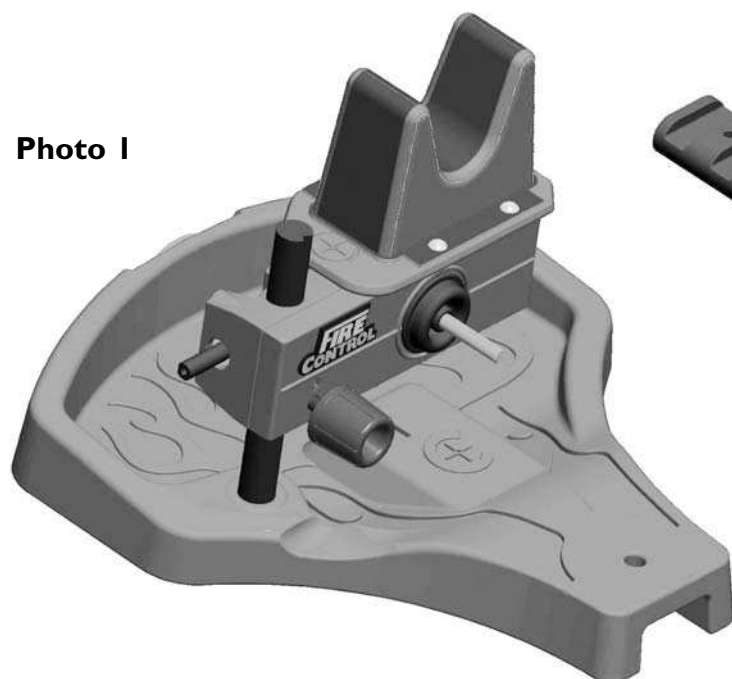

Adjustable Rail Assembly 1012047

Adjustable Tube 1004853

Toe Pad 1009496

Buttpad 1009552

Shoulder Pad 1009573

Elevation Foot 1001805



Front Base Assembly

Base 1005100

Main Block 1006785

Medium Front Filled Bag 1006255

Weight Tray Bag

1009876

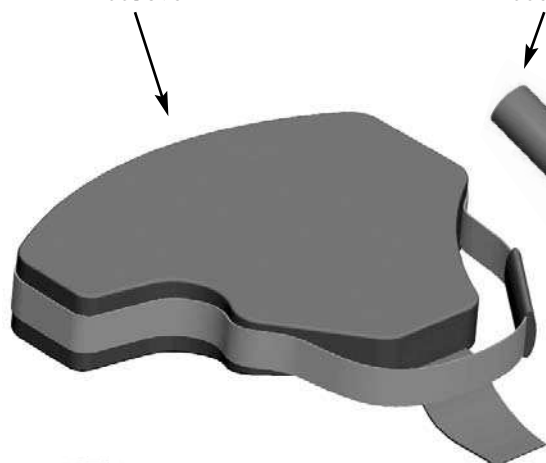

Control Arm

1006908



Filled Front Bag, Wide

1001678



Control Arm Palm Handle

579601



Control Arm Knob

744566

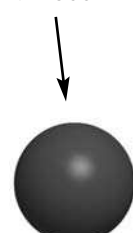

Coarse Elevation Knob

579631



Control Arm Thumbscrew

357741



Button Head Cap Screw

481393



Hex Key

1000630



Nylon Washer

1011756



Front Feet (2)

1009492



Adjustable Rail Knob

10006997

Adjustable Rail Assembly (See Photo 2)

The Adjustable Rail is designed to accommodate 5 fixed shooting length positions.

1. Simply select the desired length by interlocking the Front Base Assembly to the Adjustable Rail Assembly.
2. Align the threaded holes of the Adjustable Rail Assembly through the Front Base Assembly
3. Place the Nylon Washer onto the threaded portion of the Adjustable Rail Knob.
4. Insert the Adjustable Rail Knob and tighten.

WARNING: The LS-FCX must never be used without securing the Adjustable Rail Assembly and Front Base Assembly with the Adjustable Rail Knob. Always remove the firearm before adjusting the rest length.

Photo 2

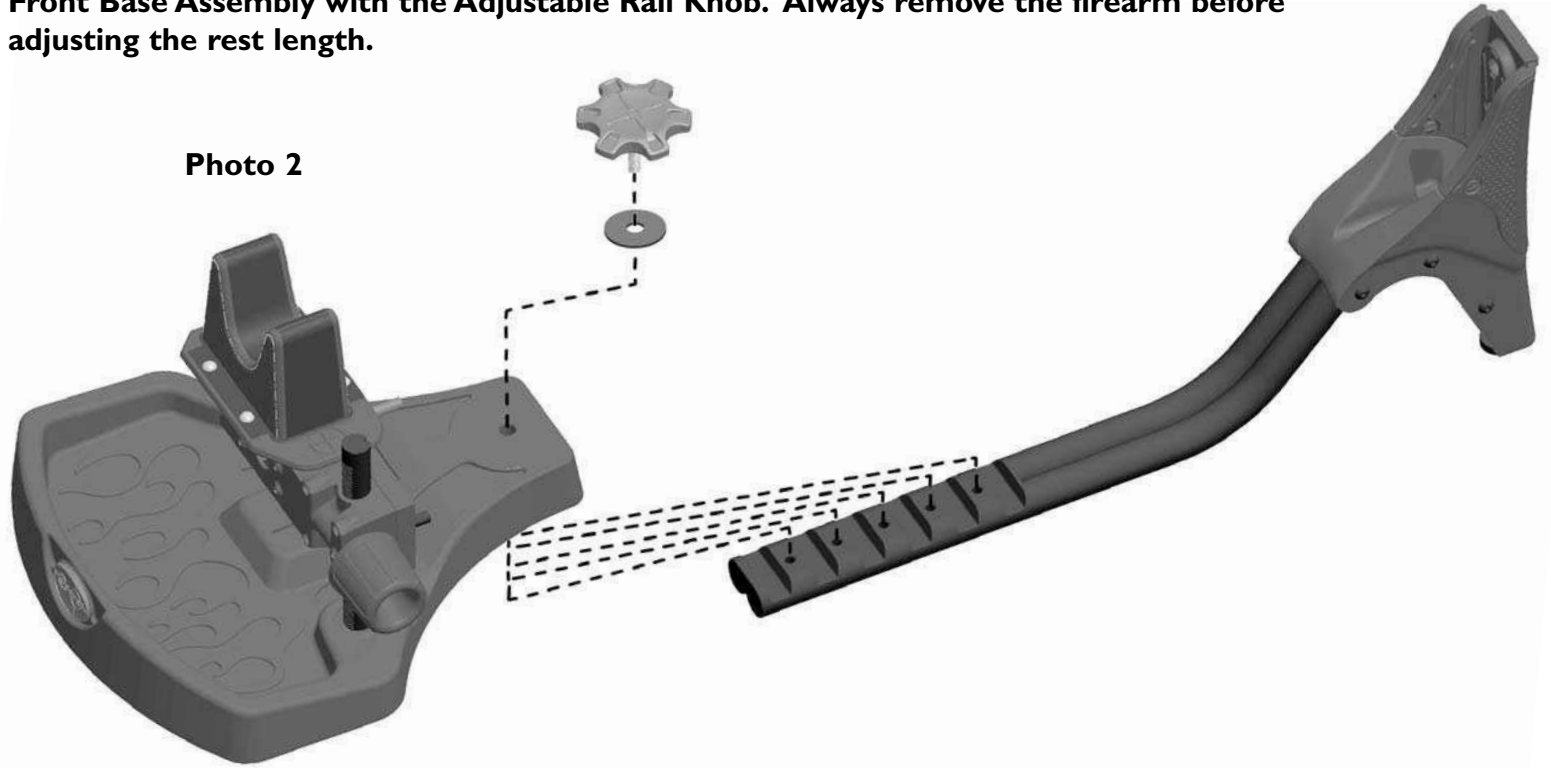

Replacing The Filled Front Bag

The rest comes with a standard profile front rest bag installed that will accommodate most guns. A wide profile front rest bag is also included for use with guns having wide foreends. Simply remove the four cap screws with the included wrench, position the bag and secure with the screws. Do not overtighten.

Control Arm Assembly (See Photo 3 on next page)

1. Slide the Control Arm over the stainless steel shaft protruding from the rubber boot. Make sure the notch in the stainless steel shaft is aligned to the threaded Thumbscrew hole of the Control Arm, thread the Thumbscrew into position and tighten.
2. Slide the palm lever over the threaded portion of the control arm with the Caldwell logo facing the rear pad assembly. Maintain a desired position of the palm handle while threading the ball knob onto the control shaft and tighten. The Control Arm can be used with or without the palm handle.

Coarse Elevation Knob Assembly (See Photo 3 on next page)

Align the Coarse Elevation Knob to the elevation shaft and tighten with the Hex Key. You may need to tap on the knob to get it started on the shaft.

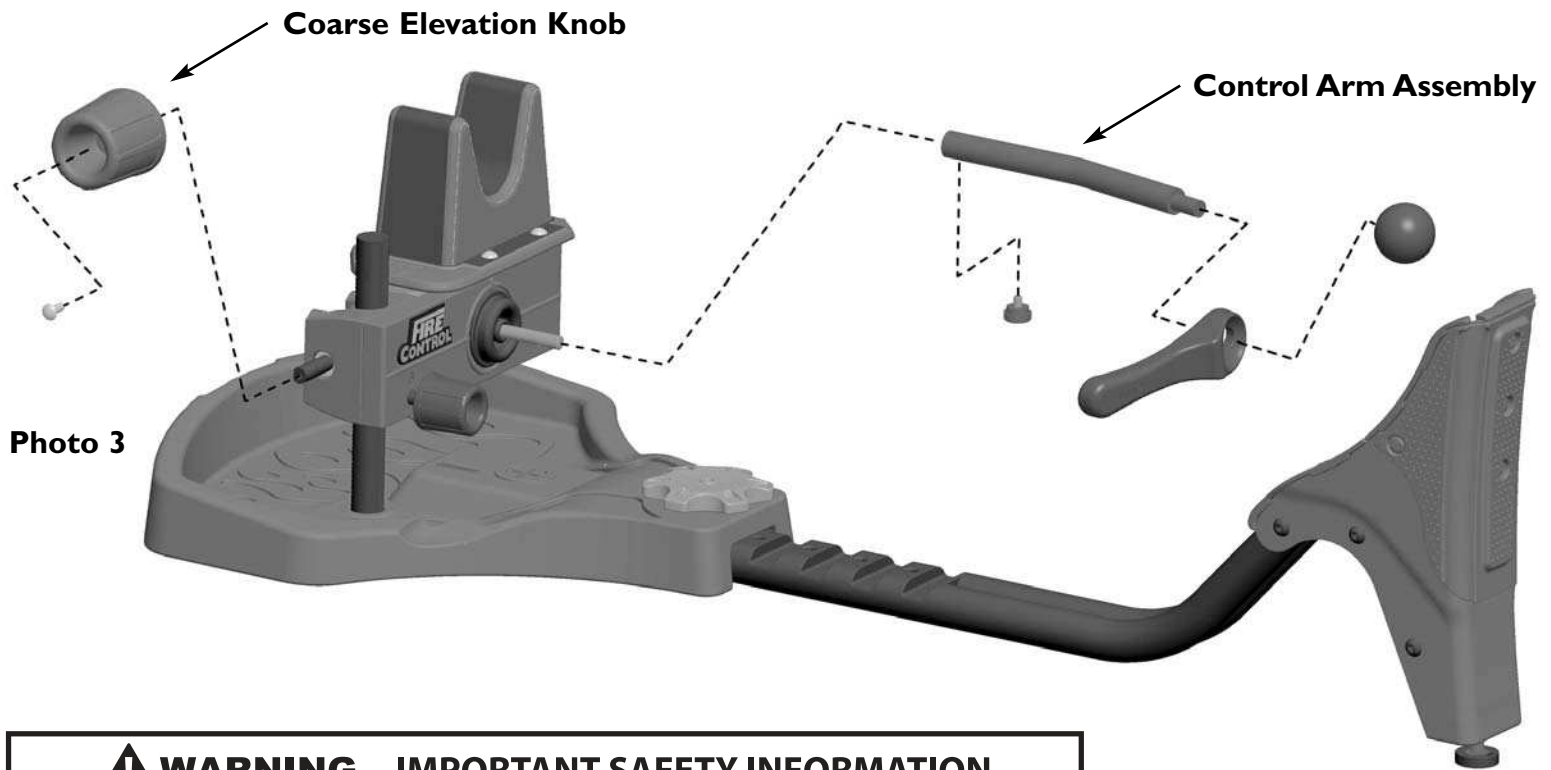

Photo 3



WARNING IMPORTANT SAFETY INFORMATION

- Always practice safe firearm handling.
- Read all product documentation before using the Lead Sled FCX.
- Keep these instructions for future use.
- Always remove weight from the front base prior to transporting the Lead Sled FCX. Failure to do so could cause injury to the shooter or damage the rest.
- Shooting from the Lead Sled FCX requires normal shooting techniques, always supporting the forend and the buttstock. If this technique is not properly applied, the captured recoil can cause the forend to jump out of the bag and possibly causing damage to the firearm or injuring the shooter.

Usage Instructions (See Photo 4)

1. Do not place the firearm on the rest yet.
2. The Lead Sled FCX rest includes a custom Weight Tray Bag for maximum recoil reduction. The bag can be filled with either sand (approx. 18 lbs) or lead shot (50 Lbs). **For instructions on filling the custom Weight Tray Bag, please see page 6.** Position the custom weight bag into the front base cavity. For best results, smooth out any voids or bulges to match the contours of the base. Our testing has shown that lead shot provides the most recoil reduction per pound. 18 lbs. of sand along with the weight of the rest itself will effectively reduce recoil to a comfortable level. However, maximum recoil reduction can be achieved by using lead shot in the included bag. And additional 25lb bag of lead shot can be added on top of the included weight tray bag, in front of the Fire Control block for extreme recoil applications. Standard 25lb lead shot bags or the Caldwell Weight Carry Bag may also be used in place of the Weight Tray Bag.

Warning: Remove the firearm when loading and unloading weight from the tray.

3. Position the assembled Lead Sled FCX on your shooting bench pointed in the direction of the target. Make sure the surface is flat and free of debris. Place the unloaded rifle or shotgun onto the Lead Sled FCX, resting the forend on the front bag and the butt in the rear recoil brace and pad assembly. Adjust length of rest as needed.

WARNING: The Lead Sled FCX must never be used without securing the Adjustable Rail Assembly and Front Base Assembly with the Adjustable Rail Knob. Always remove the firearm before adjusting the rest length.

4. Position the rest laterally to align the firearm's sights with the target. Elevation adjustments are easily made with the Coarse Elevation Knob, by slightly loosening the Elevation Lock Knob and rotating the Coarse Elevation Knob to change the height of the front rest. Re-tighten the Elevation Lock Knob when the correct elevation is attained. The Rear Elevation Foot located at the bottom of the Recoil Brace and Pad Assembly can also be used to adjust the shooting height position and elevation. Make final sight-in adjustments by manipulating the Control Arm.
5. To utilize the full benefits of the Fire Control Rest, position the rest with the Control Arm in the center of its range. This will provide the best opportunity to reestablish target sight position. Make final sight adjustments using the Control Arm to maneuver the firearm for precise target acquisition.
6. Position your firing shoulder solidly behind the rear rest and grasp the forend just as you would when using any shooting rest. Pull the firearm rearward to make certain the butt is secure against the recoil pad assembly. Before firing, always position your shoulder firmly against the rear.
7. The weight bag may require adjustments or repositioning from time to time for maximum results.

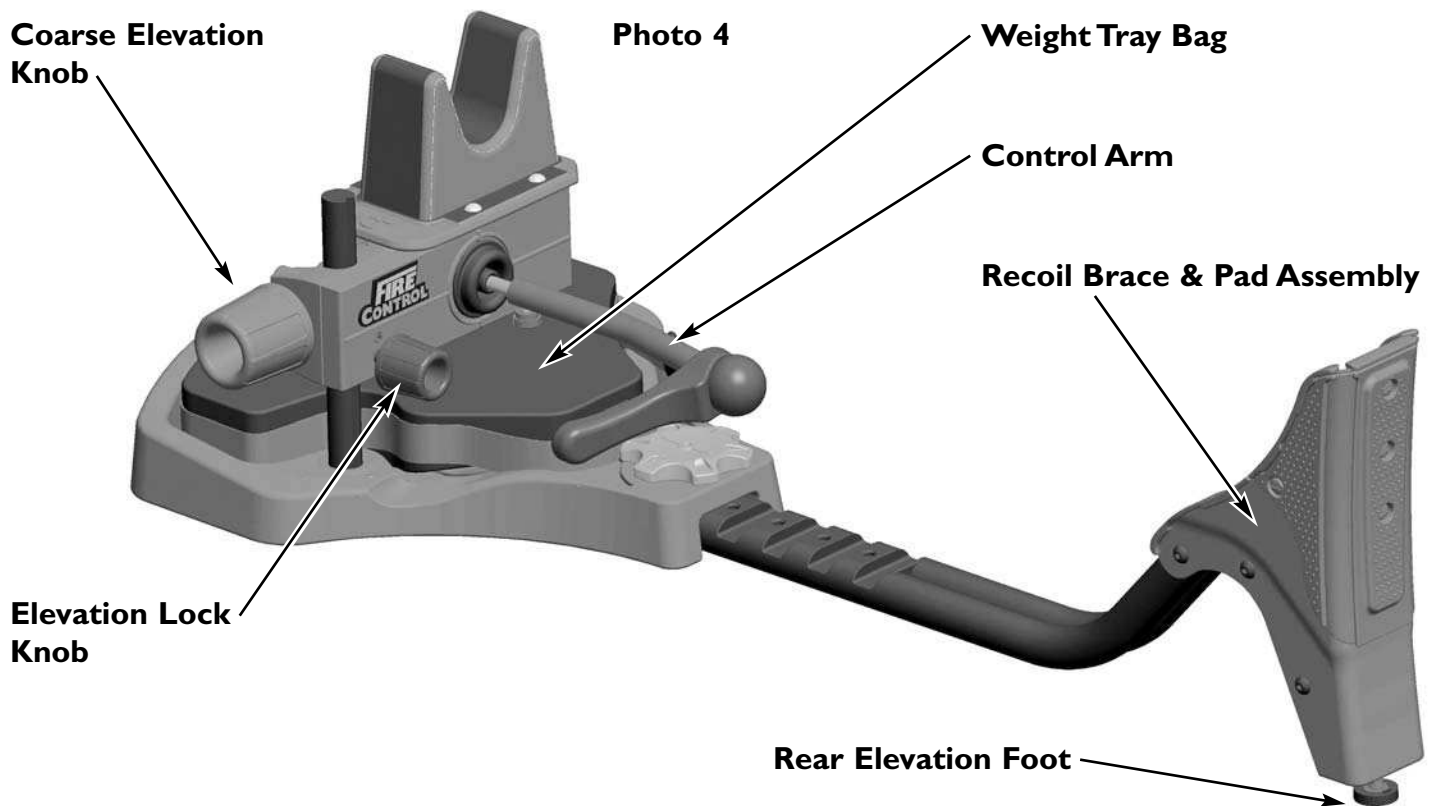

Control Arm Tension Adjustments (See Photo 5 on next page)

Although the Control Arm tension has been carefully calibrated in our manufacturing facility, normal use or personal preference may require minor adjustments. Some firearms may require more or less tension to provide the desired performance.

To adjust the operating tension of the Control Arm:

1. Locate the four set screws positioned at the front of the Main Block Assembly, (opposite side of the Control Arm).
2. Use the supplied Hex Key to make equal incremental adjustments to each of the four set screws to acquire more or less tension. Less than a 1/8 of turn will make noticeable changes to the operation of the Control Arm. **Do not over tighten the set screws**; this could damage the internal mechanism and operation of the rest. **Note: It is important to keep equal tension on all four screws.**
3. To reestablish equal tension to the four steel ball bearings, back all four set screws out until flush with the casting. The cradle will become very loose, proceed to make sequential 1/8 incremental turns to each of the four set screws until sufficient tension has been reestablished. Frequently actuate the Control Arm to test the tension during this procedure.

Photo 5

**Control Arm
Tension Adjustment,
4 Places**

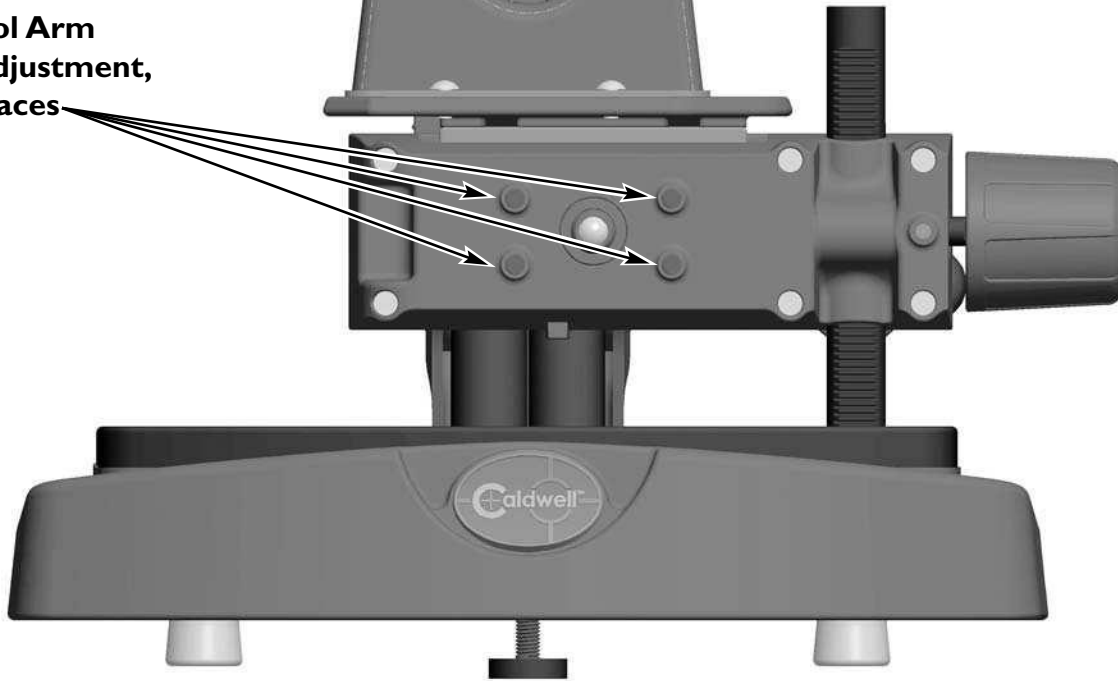

Weight Bag Filling Instructions

Find a small funnel a plastic or rubber tube, approximately 8" long. The tube must be smaller than the inside diameter of the fill spout on the Weight Tray Bag. Slip one end of the tube over the end of the funnel and tape the tube to the funnel so that it does not come off easily. Insert the other end of the tube into the spout of the weight bag and into one of the side pockets. Fill side pocket with lead shot. Then move tube to the other side pocket and fill with lead shot. Finally, fill the center pocket with lead shot and remove the tube and funnel. After filling the bag, fold the fill spout over and tuck it back under the retention strap.

WARNING: If filling the **Weight Bag** with lead shot, be sure to wash your hands thoroughly afterwards. If possible, use vinyl or nitrile disposable gloves while handling lead shot.

Storage Instructions

For best results store The Lead Sled FCX indoors in a clean and dry environment. Periodically lubricate the steel rack shaft, Rear Elevation Foot threads, and Adjustable Rail Assembly threads to prevent corrosion.