



**LAW ENFORCEMENT
QUICK
DETACH/LOCK**
UNIVERSAL PICATINNY RINGS

**PATENT
PENDING**

- Precision Machined From Aircraft-grade Aluminum Alloy with Anodized Black Matte Finish
- User Friendly Quick Detach/Lock Lever with Full Adjustability to Fit on Any Picatinny Rail
- Clever Posi-lock Cross Bolt Design and Spring Tension Controlled Locking Plate with Steel Insert Guarantees Most Secure Installation
- Great Quality at Most Affordable Price

MMUM0150-11009



**LAW ENFORCEMENT
QUICK
DETACH/LOCK**
UNIVERSAL PICATINNY RINGS

**PATENT
PENDING**

**LAW ENFORCEMENT QUICK DETACH/LOCK
UNIVERSAL PICATINNY RINGS INSTALLATION GUIDE**

Caution: Make sure firearm is not loaded. Remove magazine and examine chamber. Use safe handling procedures at all times.



Turn the Cam Lever leftward to its unlocked position. Place the QD ring on the Picatinny rail at a desired position. Seat the cross bolt at the bottom of the ring into a selected Picatinny slot.



Turn the Cam Lever from left to right to begin locking the QD ring on the rail, but do not complete the locking motion, leaving some travel distance to allow for adjustment.



Use the included Allen wrench to adjust the Hex Screw at the side of the cam for proper tension and fit against the rail. Adjust clockwise to increase the tension and tighten the clamping width. Adjust counter-clockwise to decrease the tension and increase the clamping width.



The optimal tension is achieved when the side plate first makes contact with the Picatinny rail while the Cam Lever still has enough travel left for you to securely snap into its locking position. Once you achieve the optimal tension, push the Cam Lever all the way to the right for a positive lock onto the rail.



Remove the top half of the ring by loosening the screws and slowly backing them out.

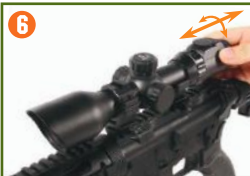

Place your scope on the ring bases. Adjust its position for comfortable eye relief and index the scope reticle for a proper horizontal level.

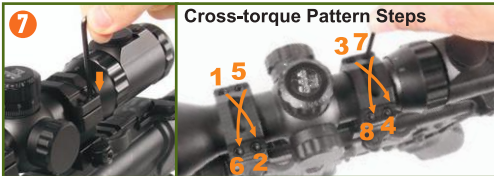

Replace the top ring halves and tighten the screws evenly by the Cross-torque Pattern. Do not over-tighten the screws as damage to scope tube may occur. It is recommended to grasp the Allen wrench by its short end to perform final tightening of the screws with torque value at about 15 inch-lb. Using the long end of the Allen wrench to tighten ring screws will result in over-tightening and may cause permanent damage to rings and deformation of scope tube.

You may repeat Step 3 and 4 if needed to find the best clamping tension and locking position for your rings on the rail.